



US00D630266S

(12) **United States Design Patent**
Frank et al.

(10) **Patent No.:** **US D630,266 S**
(45) **Date of Patent:** **** Jan. 4, 2011**

(54) **COLLAPSIBLE, PORTABLE PUPPET STAGE**

(76) Inventors: **Carolyn T. Frank**, 376 N. Pleasant View Dr., Kaysville, UT (US) 84037; **Gregory A. Frank**, 376 N. Pleasant View Dr., Kaysville, UT (US) 84037

(**) Term: **14 Years**

(21) Appl. No.: **29/360,590**

(22) Filed: **Apr. 28, 2010**

Related U.S. Application Data

(63) Continuation of application No. 12/098,555, filed on Apr. 7, 2008.

(51) **LOC (9) Cl.** **21-01**

(52) **U.S. Cl.** **D21/506**

(58) **Field of Classification Search** D21/506,
D21/837, 839; D25/49, 53, 58; D6/332,
D6/392, 396, 397, 429, 449, 458, 509; D20/10;
40/160, 605, 610; 52/109, 633, 645, 646,
52/648.1, 653.1; 135/143, 147, 151, 157;
160/130, 135; 211/189, 195, 200; 446/57,
446/71, 75, 82, 83, 84

See application file for complete search history.

(56) **References Cited**

U.S. PATENT DOCUMENTS

2,368,188 A * 1/1945 Wise 446/82

(Continued)

OTHER PUBLICATIONS

Normadic Display, Owners Manual, Jul. 17, 1997, pp. 1-45.

Primary Examiner—Cynthia M Chin

(74) *Attorney, Agent, or Firm*—Warren M. Pate, LLC

(57) **CLAIM**

The ornamental design for a collapsible, portable puppet stage, as shown and described.

DESCRIPTION

FIG. 1 is a perspective view of a collapsible, portable puppet stage in accordance with our new design in a deployed configuration;

FIG. 2 is a front elevation view of the design of FIG. 1 in the deployed configuration;

FIG. 3 is a back elevation view of the design of FIG. 1 in the deployed configuration;

FIG. 4 is a top plan view of the design of FIG. 1 in the deployed configuration;

FIG. 5 is a bottom plan view of the design of FIG. 1 in the deployed configuration;

FIG. 6 is a side elevation view of the design of FIG. 1 in the deployed configuration;

FIG. 7 is an opposite side elevation view of the design of FIG. 1 in the deployed configuration;

FIG. 8 is a perspective view of the design of FIG. 1 in a partially deployed/stowed configuration;

FIG. 9 is a perspective view of the design of FIG. 1 in the stowed configuration;

FIG. 10 is a perspective view of the design of FIG. 1 in the deployed configuration with barrier material applied;

FIG. 11 is a front perspective view of the design of FIG. 1 in the deployed configuration with barrier material applied;

FIG. 12 is a back perspective view of the design of FIG. 1 in the deployed configuration with barrier material applied;

FIG. 13 is a top plan view of the design of FIG. 1 in the deployed configuration with barrier material applied;

FIG. 14 is a bottom plan view of the design of FIG. 1 in the deployed configuration with barrier material applied;

FIG. 15 is a side elevation view of the design of FIG. 1 in the deployed configuration with barrier material applied; and,

FIG. 16 is an opposite side elevation view of the design of FIG. 1 in the deployed configuration with barrier material applied.

The broken lines represent portions of the design that form no part of the claim.

1 Claim, 12 Drawing Sheets

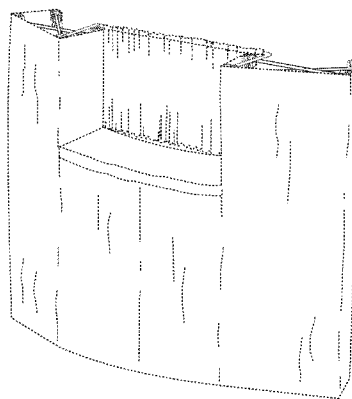
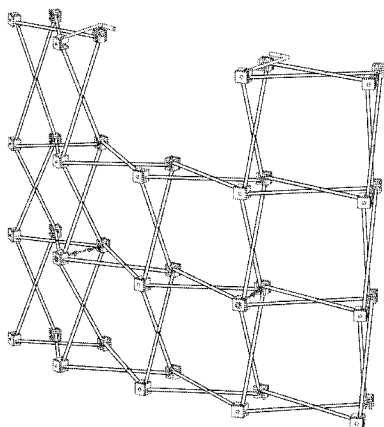

US D630,266 S

Page 2

U.S. PATENT DOCUMENTS

2,718,091 A *	9/1955	Schrock	446/84	4,970,841 A	11/1990	Zeigler	
3,899,168 A	8/1975	Besherse		5,123,550 A *	6/1992	Nodskov et al.	211/189
D247,721 S	4/1978	Wax		5,125,205 A *	6/1992	Wichman	52/646
4,280,521 A	7/1981	Zeigler		5,230,196 A *	7/1993	Zeigler	52/646
4,512,097 A	4/1985	Zeigler		5,261,849 A	11/1993	French	
4,522,008 A	6/1985	Zeigler		5,351,843 A *	10/1994	Wichman et al.	211/195
4,580,375 A	4/1986	Nodskov et al.		5,501,051 A *	3/1996	Harlan	52/646
D286,108 S *	10/1986	Hanlon	D6/449	D405,976 S *	2/1999	Beall	D6/396
4,658,560 A	4/1987	Beaulieu		D420,223 S *	2/2000	Chipman et al.	D6/332
4,721,490 A	1/1988	Draugelis		6,250,039 B1 *	6/2001	Karten et al.	52/645
4,764,142 A	8/1988	Griffith et al.		6,460,946 B1	10/2002	Beukema	
4,800,663 A	1/1989	Zeigler		6,506,093 B2	1/2003	Avital	
D299,985 S *	2/1989	Helstab	D6/332	6,553,698 B1	4/2003	Kemeny	
4,857,028 A	8/1989	Pail		6,663,456 B2	12/2003	Gemma, Jr.	
4,888,895 A *	12/1989	Kemeny	40/610	6,799,594 B2	10/2004	Kuo	
4,942,686 A *	7/1990	Kemeny	40/610	6,829,869 B1 *	12/2004	Savoie	52/648.1
D312,282 S *	11/1990	Kelly	D21/506	6,981,350 B1 *	1/2006	Redmon	52/646
				7,020,993 B2 *	4/2006	Pritchard	40/610

* cited by examiner

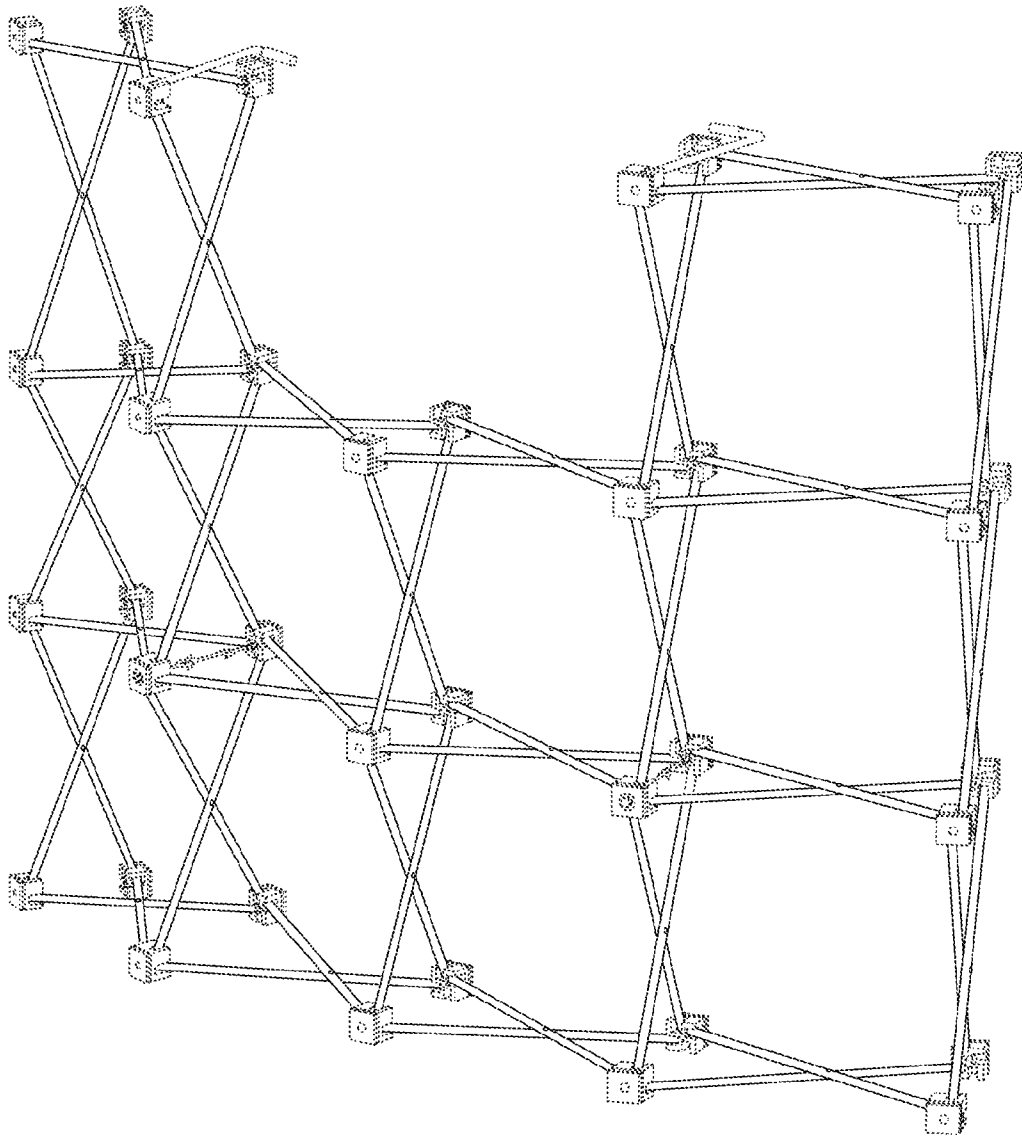

FIG. 1

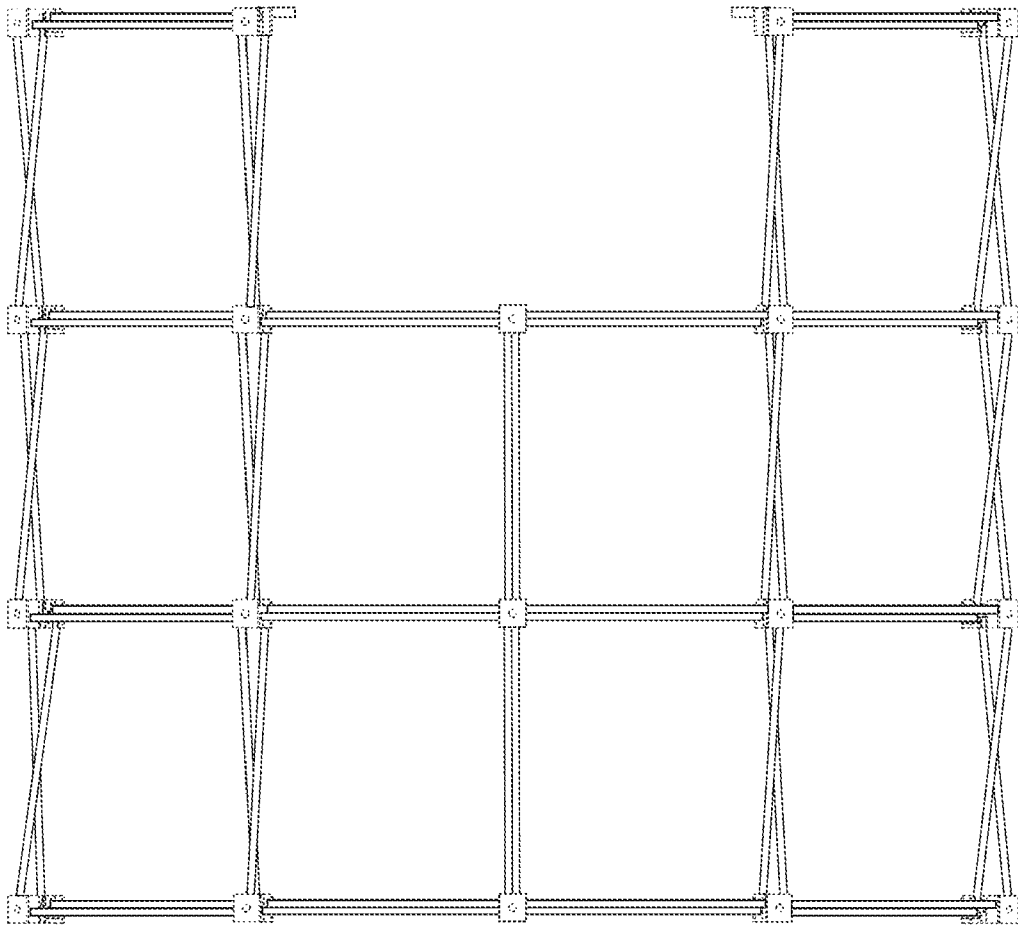

FIG. 2

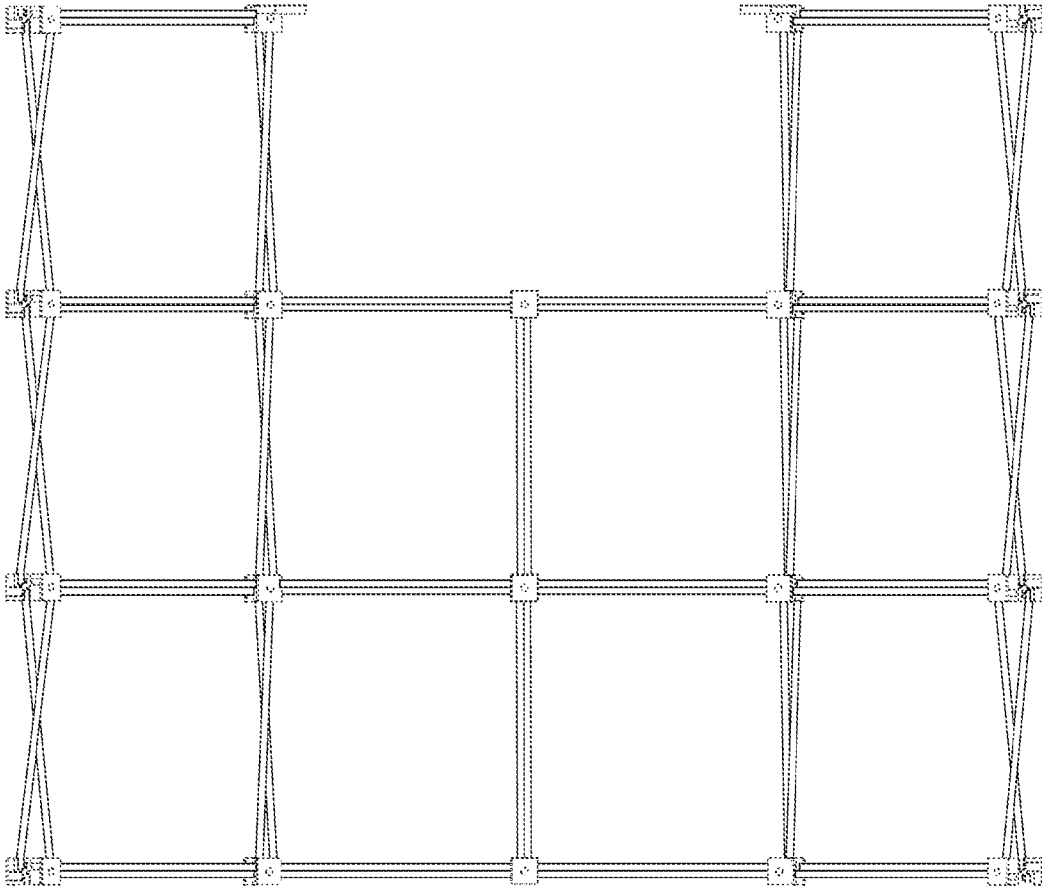

FIG. 3

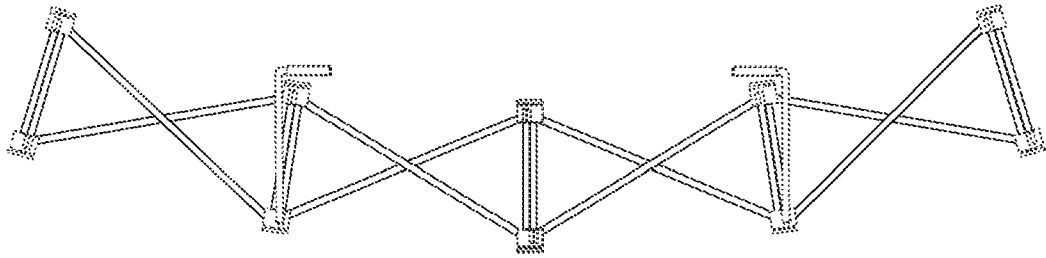

FIG. 4

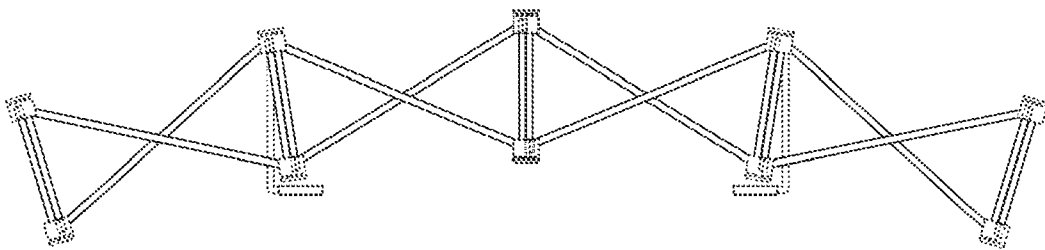

FIG. 5

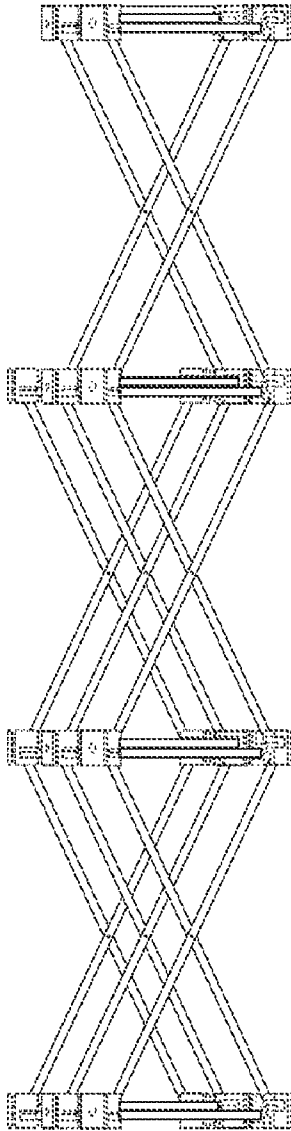

FIG. 6

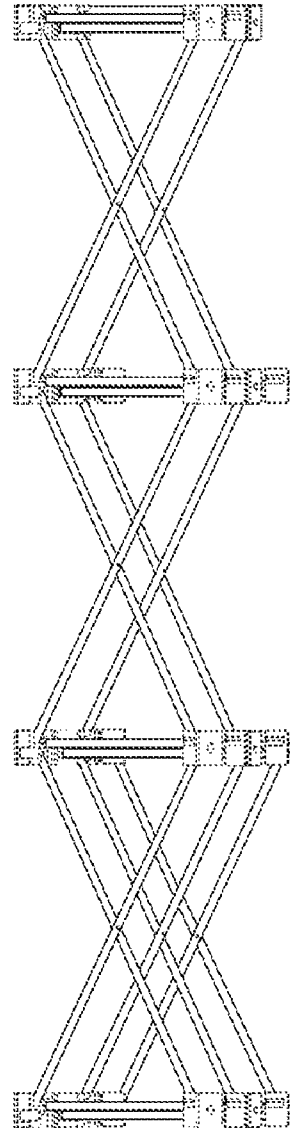

FIG. 7

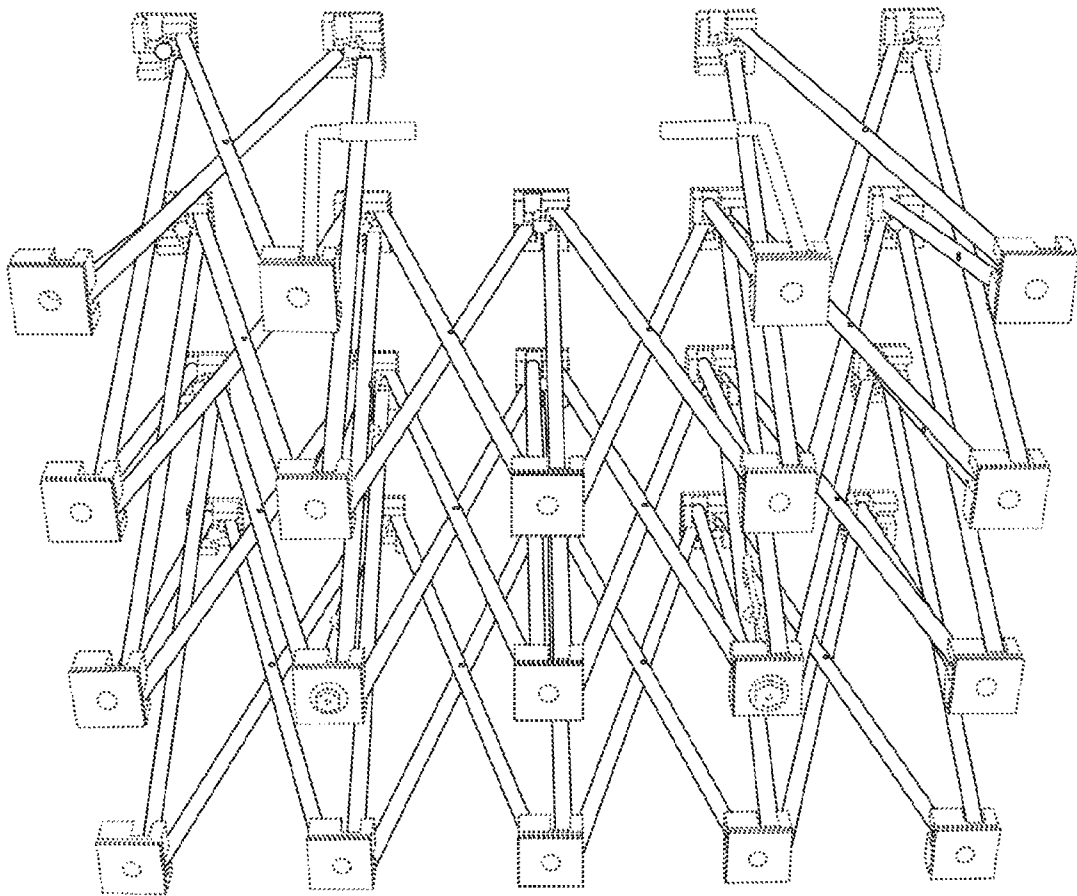

FIG. 8

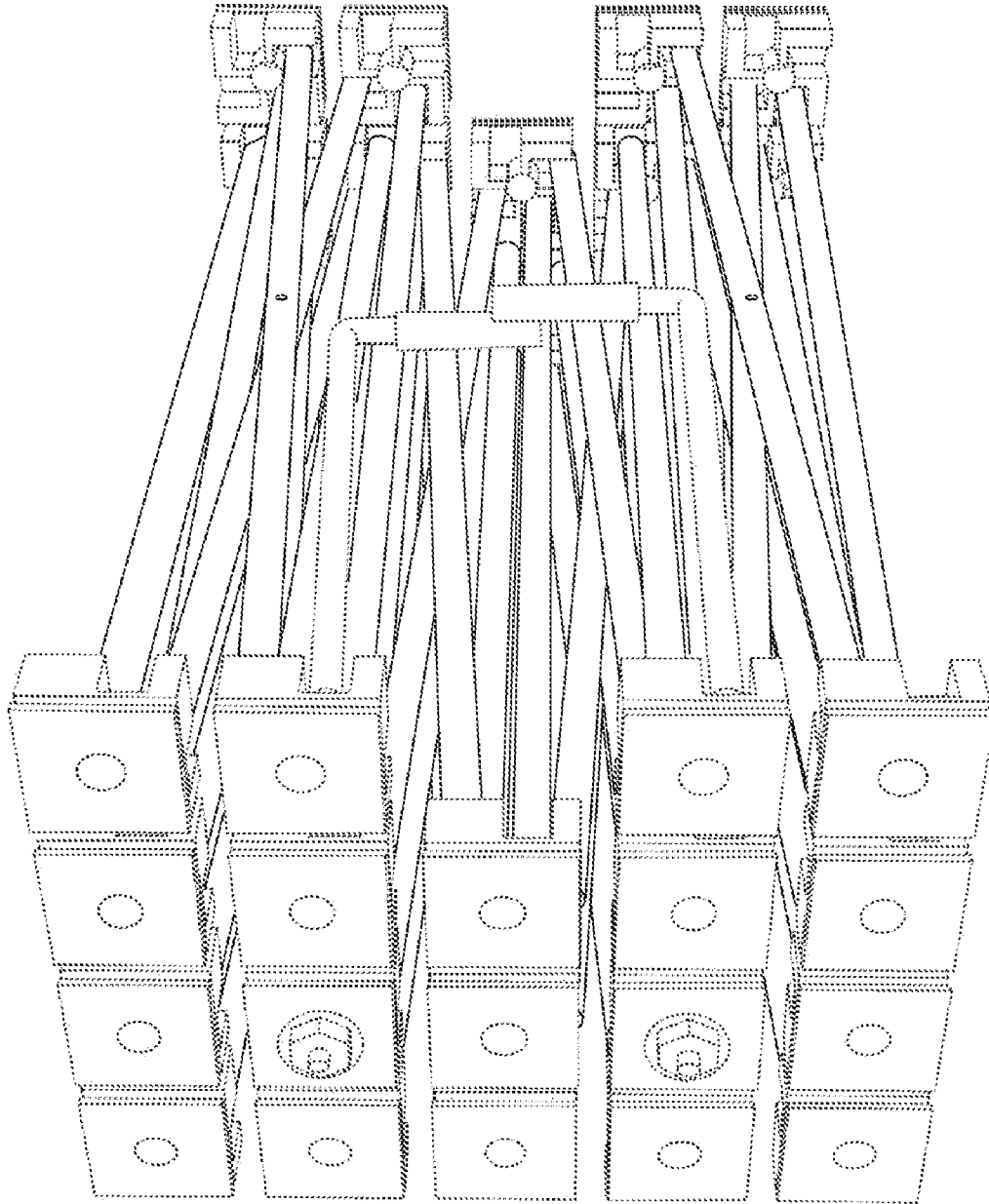

FIG. 9

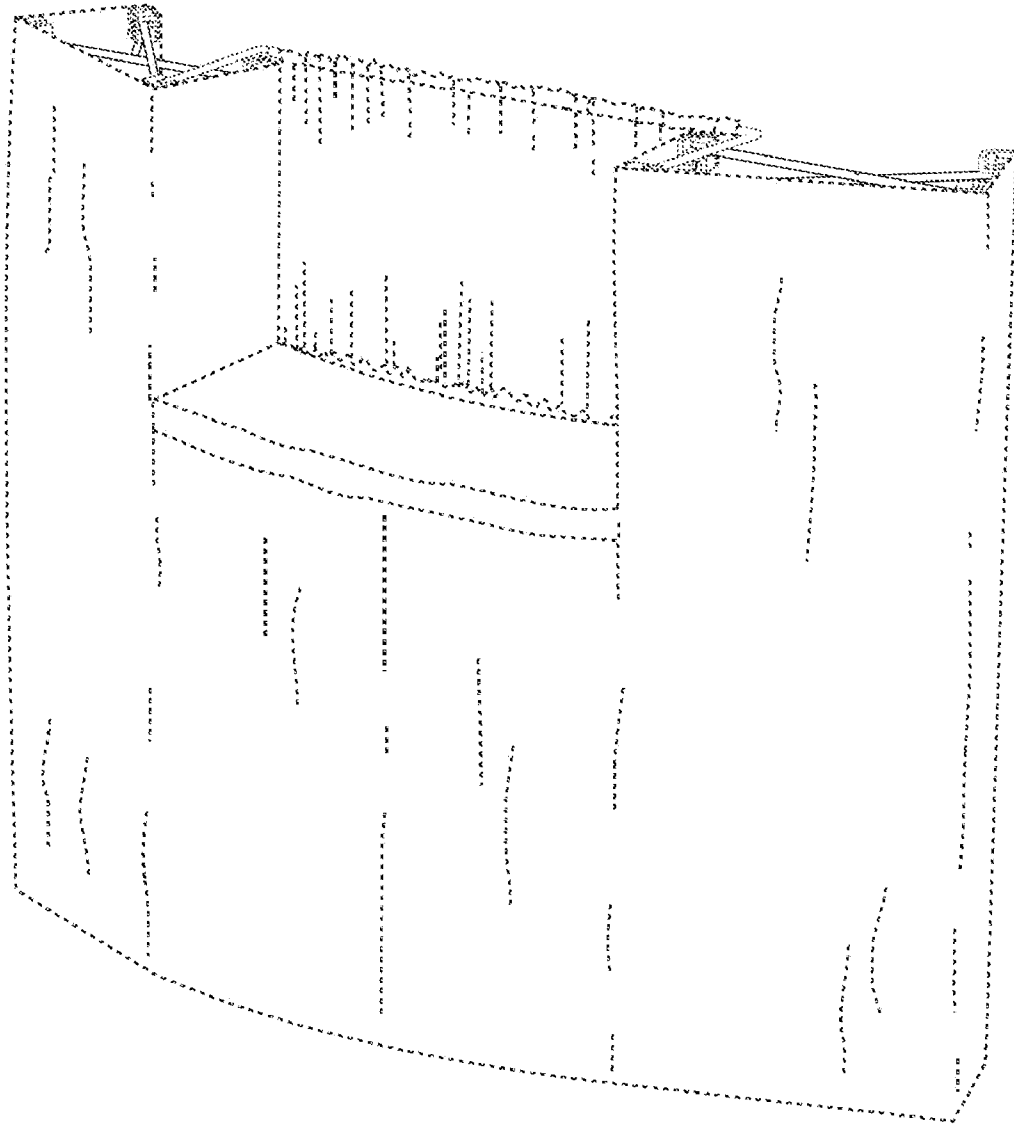

FIG. 10

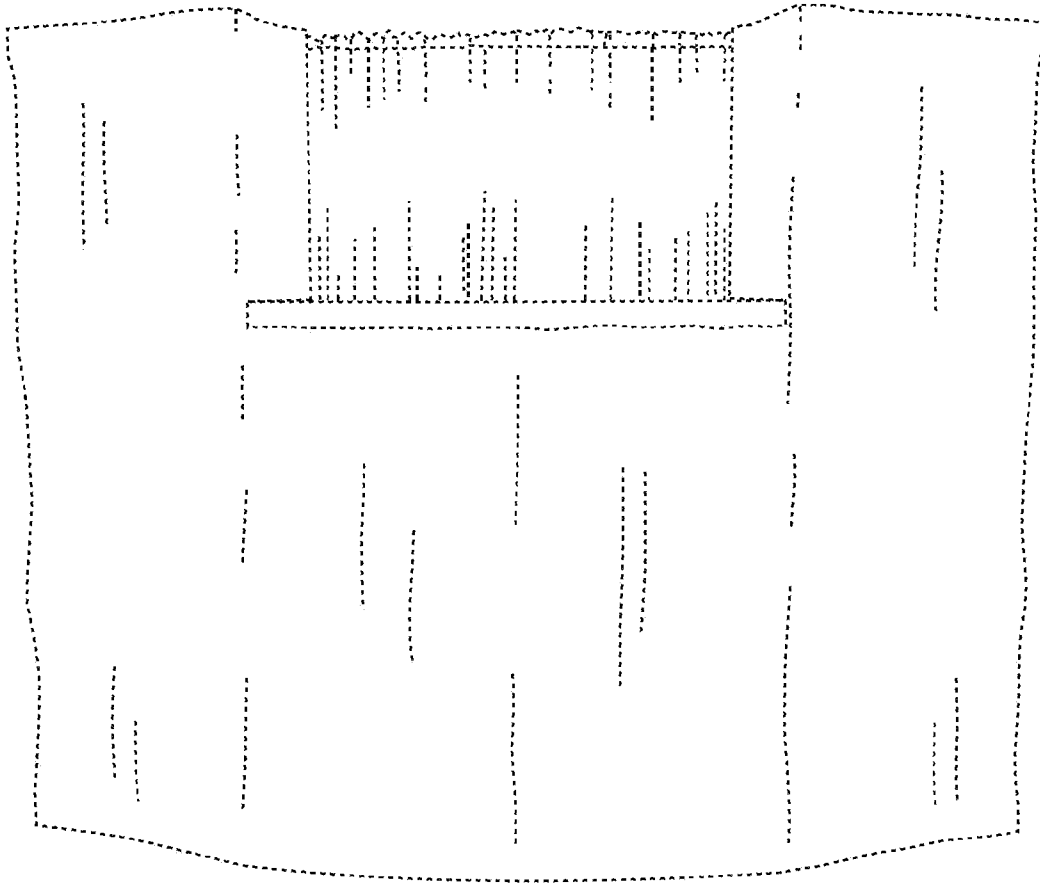

FIG. 11

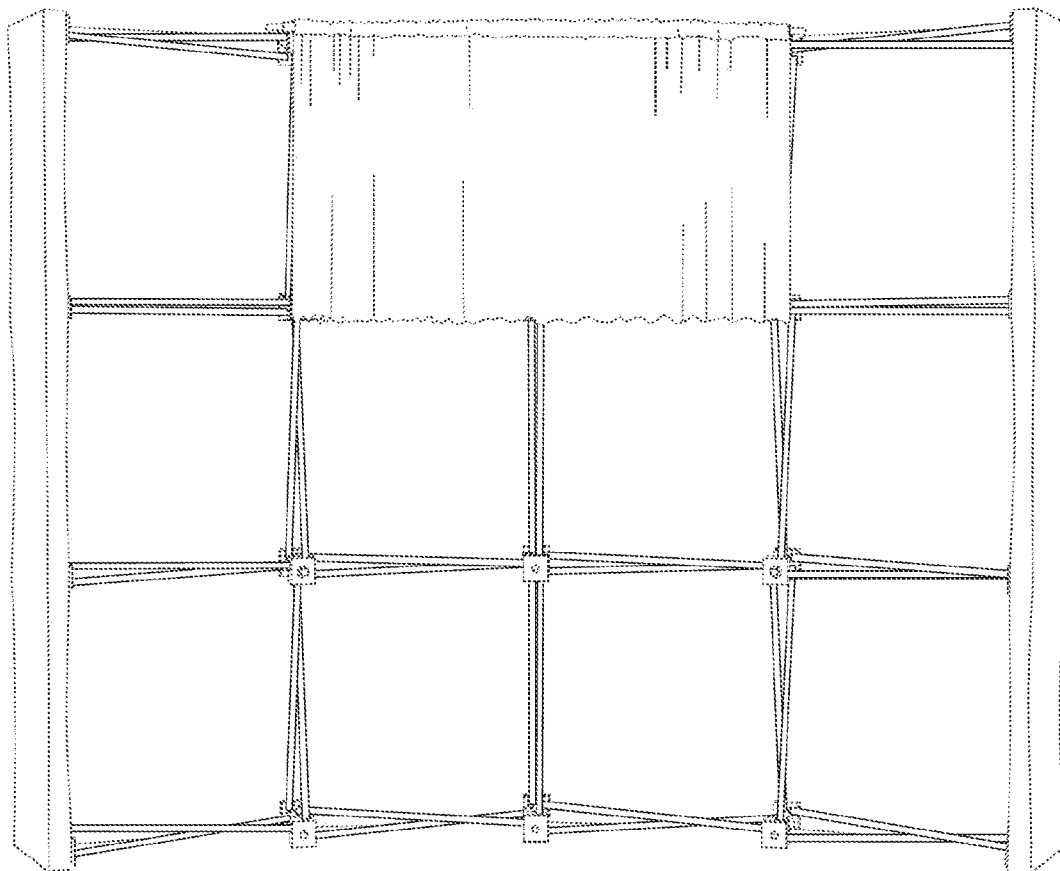

FIG. 12

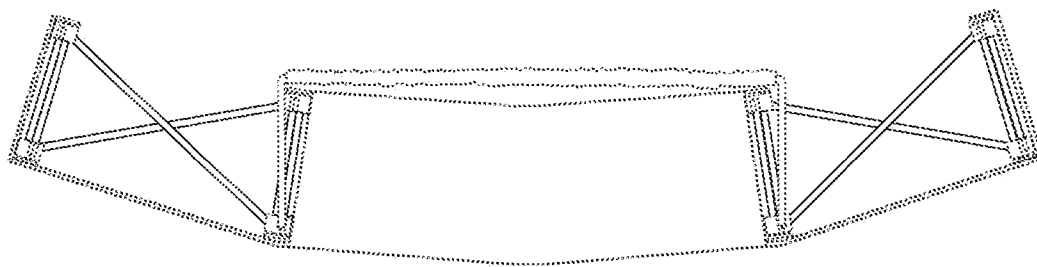

FIG. 13

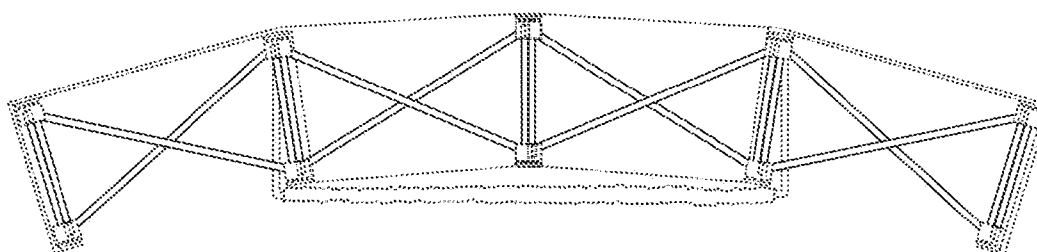

FIG. 14

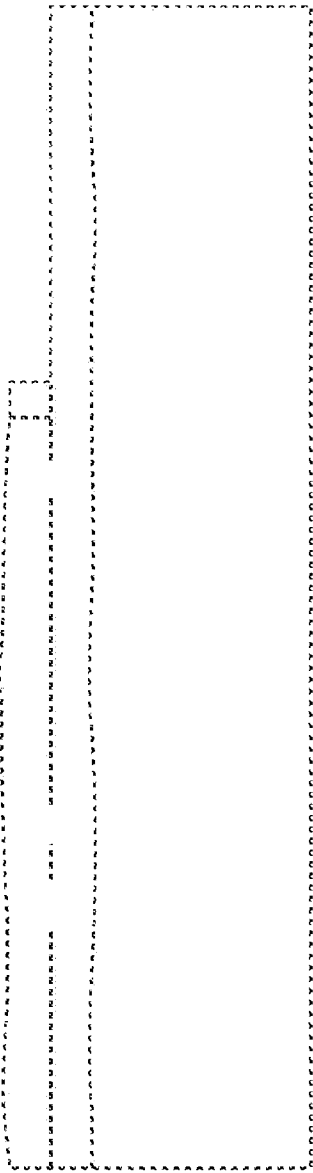

FIG. 15

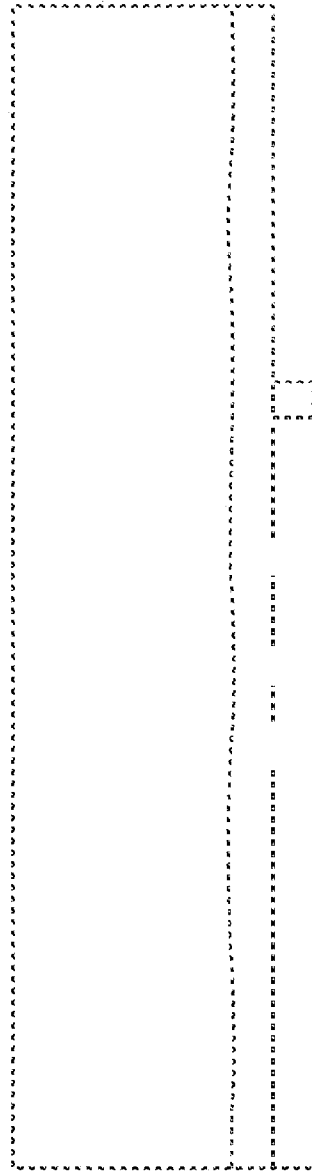

FIG. 16